

**Quick Ship**

Project: \_\_\_\_\_

Fixture Type: \_\_\_\_\_ Quantity: \_\_\_\_\_

Customer: \_\_\_\_\_



**Illuminating**  
ENGINEERING SOCIETY

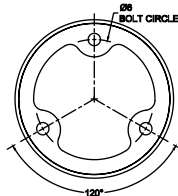
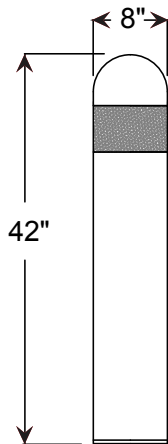

**Specifications**

**Material:**  
All parts are durable, high strength aluminum extrusion and spinings. All mounting hardware shall be stainless steel or zinc plated steel.

**Lens:**  
Frosted acrylic lens

**Electrical:**  
Medium Base Socket.

**Mounting:**  
Standard anchor bolts are 3/8" x 12" x 3". Bolts, nuts and washers shall be hot dipped galvanized steel. Bolt pattern diameter is 6".

**Finish:**  
A polyester powder coat high quality finish is electro-statically applied and baked at 430° for exceptional durability and color retention. Products undergo an intensive five-step cleansing and pretreatment process for maximum paint adhesion.

Marine grade finish provides superior salt, humidity and UV protection. This coating withstands up to 3000 hours of continuous salt spray, comes with a 5-year warranty and is available in either a textured or gloss surface.

**Modifications:**  
Consult factory for custom or modified designs.

**Q-BL6011**  
**100w Max Incandescent**

Weight: 22 lbs

**Catalog Logic**

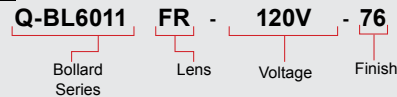

**Catalog Number**

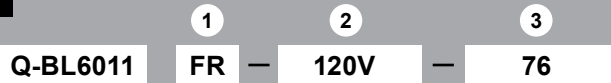

1	LENS
CL	(Clear Acrylic)
FR	(Frosted Acrylic)

2	VOLTAGES			
	120	208	240	277

3 FINISHES			
Standard Grade	Marine Grade		Standard Grade
40	NA	Raw Unfinished	53
41	101	Black	56
42	102	Forest Green	61
43	114	Bright Red	70
44	107	White	71
45	112	Bright Blue	72
46	123	Sunny Yellow	73
47	120	Aqua Green	76
49	NA	Galvanized	77
50	111	Navy	78
51	103	Architectural Bronze	10
52	104	Patina Verde	11
12	133	Lilac	13
	100	Copper Clay	
	109	Silver	
	106	Black Verde	
	118	Painted Chrome	
	105	Painted Copper	
	108	Textured Black	
	125	Matte Black	
	121	Textured Architectural Bronze	
	127	Textured White	
	124	Textured Silver	
	130	Aspen Green	
	131	Cantaloupe	
	132	Putty	

**WARRANTY**

See [www.anplighting.com](http://www.anplighting.com) for complete warranty